

! CAUTION

- All wiring should be done by a licensed electrician in accordance with state codes, local codes, National Electric Code (NEC) standards and International Electrotechnical Commission (IEC) standards.
- Improper installation may result in serious injury and void warranty.
- Keep plugs and receptacles dry. This fixture should only be used on Ground Fault Circuit Interrupter (GFCI) protected circuits.
- Contains parts and assemblies susceptible to damage by electrostatic discharge (ESD).
- When using luminaires, basic safety precautions should always be followed to reduce the risk of fire, electric shock and personal injury. When used in wet locations, circuit(s) or outlet(s) must have GFCI protection. Receptacles with built-in GFCI protection should be used for this measure of safety.

To Remove the LED Assembly

1. Loosen outer gear (Item 1) and hexagon nut (Item 9) from each end of fixture. This will allow the entire end cap assembly to be removed from the PC tube (Item 5).
2. Remove end cap assembly from PC tube (Item 5).
3. Remove LED assembly (Item 10) from PC tube (Item 5) by rotating the LED assembly 90° inside the PC tube (Item 5). The LED assembly (Item 10) should then slide out.

To Reassemble the Fixture

1. Insert LED assembly (Item 10) into PC tube (Item 5) and rotate 90° so the LED assembly (Item 10) is between the notches in the PC tube (Item 5).
2. Insert entire end cap assembly into PC tube (Item 5).
3. Tighten outer gear (Item 1) and hexagon nut (Item 9) on each end of fixture.

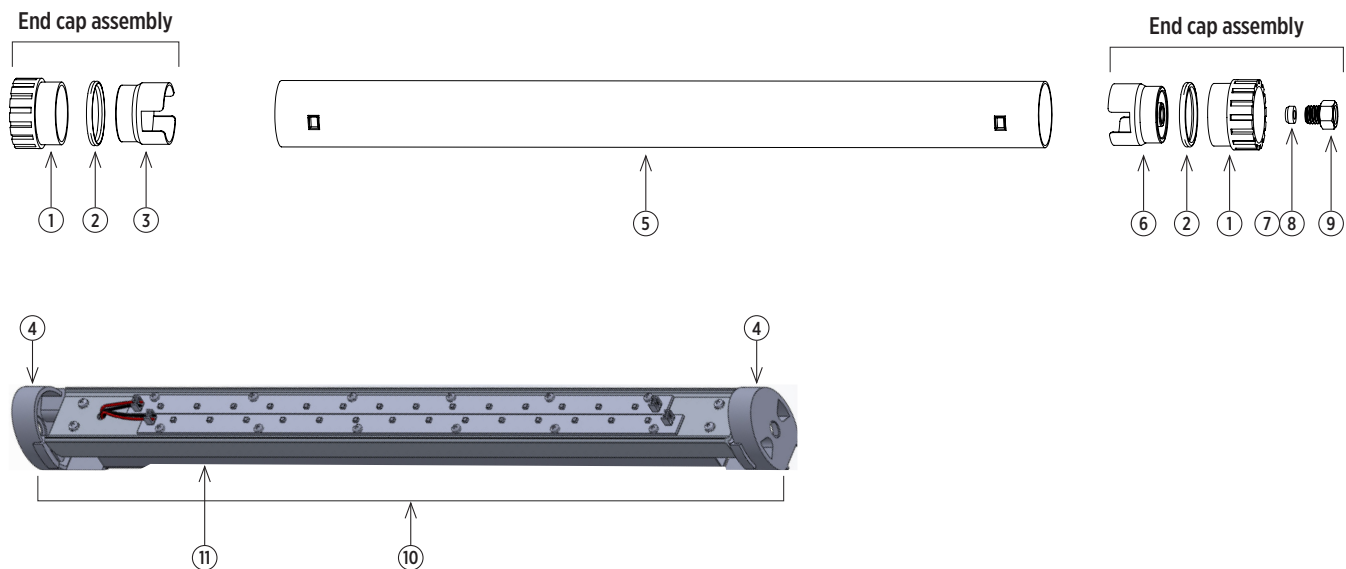

Repair Parts List

Item	Part Number	Quantity	Description
1	5112250	2	outer gear
2	5009330	2	seal ring
3	5112240	1	inner end cap (without hole)
4	5112230	2	LED tray end cap
5	5112235	1	28 inch PC tube
6	5112247	1	inner end cap (with hole)
7	5009340	1	cord seal (300v)
8	5009345	1	cord seal (600v)
9	5112255	1	hexagon nut
10	contact factory	1	LED assembly
11	contact factory	1	driver

Wiring

Standard (US) Cord	DC Cord
black : line	black : negative (-)
white : neutral	white : positive (+)
green : ground	

Electric Parameters	AC Fixtures	DC Fixtures
input voltage	120-277V	12-24V
input frequency	50/60Hz	n/a
input power	17W	17W

Product design and specifications are subject to change without notice.