

**! CAUTION**

- All wiring should be done by a licensed electrician in accordance with state codes, local codes and National Electric Code (NEC) standards.
- Improper installation may result in serious injury and void warranty.
- Fixture surface may be hot. Risk of burns. Do not operate without wire guard (see repair parts list below).
- Heat from lamp may char or ignite flammable materials. When installed near flammable materials (including doors), the following precautions must be taken:
  - Do not place fixture with 12 inches of flammable material
  - Use wire guard to prevent fixture contact with flammable materials

**Wiring**

Install the male plug from the light head into the female receptacle adjacent to the switch in the arm assembly.

Install the male plug from the arm assembly into the nearest supply outlet (120V AC only). A rocker switch is built into the splice compartment on the arm assembly.

Green is ground (PE), black is line and white is common.

**Lamps (optional)**

A lamp is not provided as standard on the DL-INC-LH. Optional 18W PAR38 LED lamp is available (LMP). Fixture is designed to accommodate up to a 90W PAR38 lamp.

**Wire Guard Installation**

1. Slip the two (2) straight prongs of the guard inside the fixture housing.
2. Catch the top guard hook over the top rolled edge of the fixture housing.
3. Pull down on the opposite guard hook and snap the hook over the lower fixture rolled edge (see Figure 1).

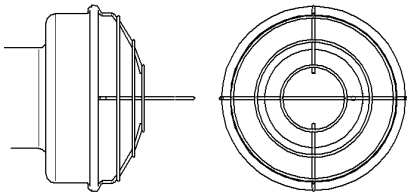
**Figure 1****Mounting**

The modular light head is mounted to the Phoenix modular arm using a carriage bolt.

1. Install end cap. Then insert carriage bolt through arm, washer and then harp. Use lock washer and nut to secure as shown in Figure 2.

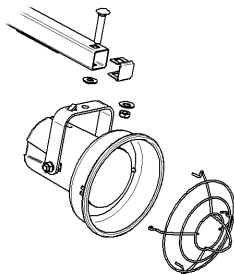
**Figure 2**

# Modular *docklite*® Head Assembly

## Installation Instructions

**PHOENIX**®  
DURABILITY X DESIGN™

### Repair Parts List

Item	Description	Part Number
1	harp kit (includes item #2 below)	000030.902
2	mounting hardware	1155800
3	wire guard	7508107
4	cord set	4130070
5	socket kit	1160040
6	swivel stop kit	1155820

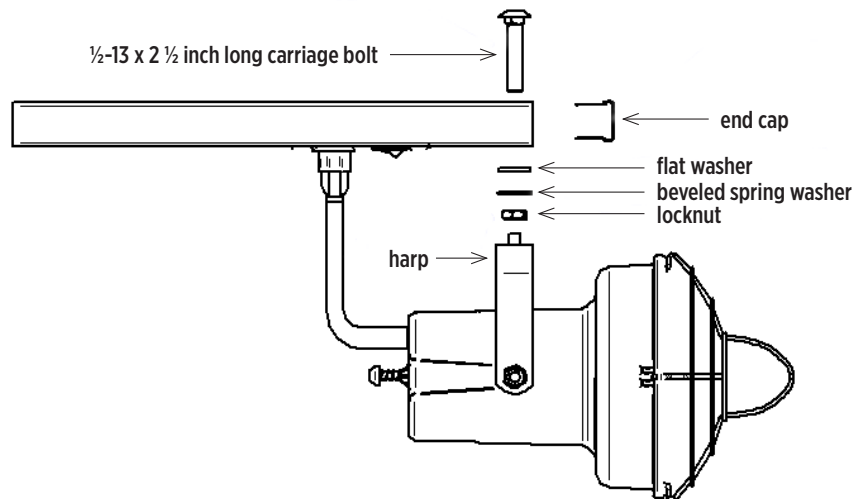

Product design and specifications are subject to change without notice.