

# Metallic LED VP Series

## LED Vaporproof Fixture

US Patent No. D642,327, US8,348,476 B2 and D650,518

Marine grade aluminum vaporproof fixtures UL rated for hazardous and wet locations

Durable design with an array of mounting and globe options

For use on marine vessels, mining equipment, tankers and other demanding applications

LED technology increases efficiency, eliminates maintenance and supports green initiatives

## Key Applications

Walkways, doorways and stairwells  
Perimeter lighting  
Exterior and interior decks  
Machine, electrical and engine rooms  
Parking garages  
Transportation centers and subways  
Swimming pools, locker rooms, car washes and other wet locations  
Automotive repair facilities

## Compliances

UL/cUL Certified to:

- UL 1598 Suitable for Wet Locations
- UL 1598A Marine Outside Type (Saltwater)
- UL 844 Hazardous Location
  - Class I, Division 2 Groups A, B, C, D
  - Class I, Zone 2
  - T3A, 180°C maximum surface temperature
  - Class II, Division 2 Groups F, G
  - T4A, 120°C maximum surface temperature
- CSA C22.2 No. 137-1981
- CSA C22.2 No. 250.0-08

IP66 rated

ABS

## Specifications

|                     |  |
|---------------------|--|
| <b>Construction</b> | Ultra-low copper content, marine grade aluminum<br>Long-life silicone gaskets  |
| <b>Globe</b>        | Frosted heat treated glass (FGC) or Amber heat treated glass (GHA) - standard<br>Additional globe options available as accessories |

## Specifications

|                                      |  |
|--------------------------------------|--|
| <b>Guard</b>                         | All fixtures come with a guard. Discard guard if not needed.<br>Ultra-low copper content marine grade aluminum   |
| <b>Hardware</b>                      | Marine grade (316) stainless steel external hardware   |
| <b>Grounding</b>                     | Junction boxes include hardware to ground the fixture  |
| <b>Light source</b>                  | 17W, 1300 lumens<br>Cool white (5600K) and warm white (3000K) options<br>Sealed in optically clear silicone<br>50,000 hour rated life  |
| <b>Power source</b>                  | 100-277V AC, 50-60Hz<br>0-10V dimming - standard<br>Class 2 rated driver - standard<br>Fully potted<br>Over-voltage, over-current, short-circuit protection with auto recovery |
| <b>Ambient operating temperature</b> | -30°C to +40°C (certified to)<br>-45°C to +40°C (tested to)  |
| <b>Ambient storage temperature</b>   | -40°C to +40°C (certified to)<br>-52°C to +40°C (tested to)  |
| <b>Mounting</b>                      | Wall (bulkhead) or ceiling mount   |
| <b>Outlets</b>                       | One ½ inch NPT outlet for power connection   |
| <b>Weight</b>                        | Ceiling mount configuration: 5.0 lb (2.3 kg)<br>Wall mount configuration: 6.0 lb (2.7 kg)<br>Add approximately 1.0 lb to each for shipping weight                              |
| <b>Warranty</b>                      | 5 years  |

For IES files, see website or contact factory

# Metallic LED VP Series

LED Vaporproof Fixture

**PHOENIX**<sup>®</sup>  
DURABILITY X DESIGN™

## Dimensions

Ceiling Mount Configuration

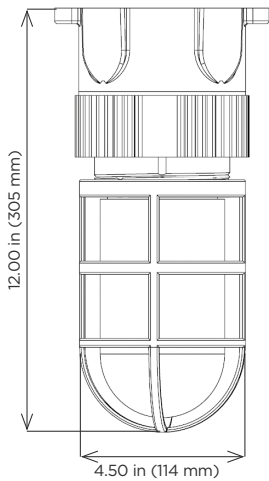

Wall Mount Configuration

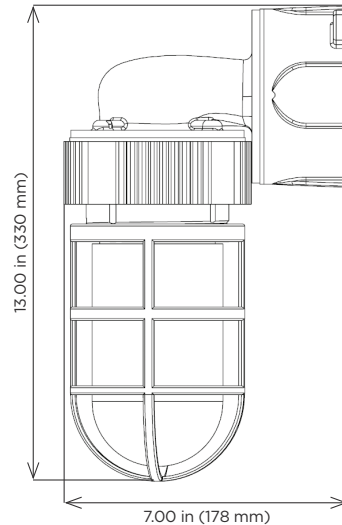

Mounting Dimensions

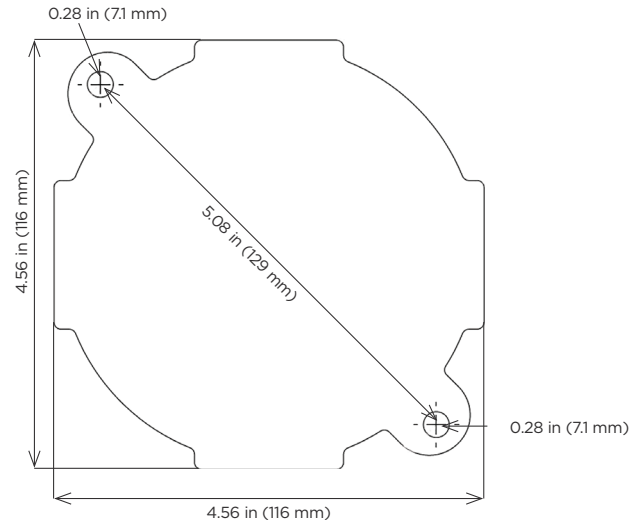

## Ordering Information

Example: VA-W-17LED-CW-FGC

| Fixture | Mount | Wattage/Type | Color Temperature | Globe <sup>1</sup> |
|---------|-------|--------------|-------------------|--------------------|
| VA      | W     | 17LED        | CW                | FGC <sup>2</sup>   |
|         |       |              | WW                | GHA <sup>2</sup>   |

| Fixture |          | Mount |                    | Wattage/Type |     | Color Temperature |                    | Globe <sup>1</sup> |                            |
|---------|----------|-------|--------------------|--------------|-----|-------------------|--------------------|--------------------|----------------------------|
| VA      | Aluminum | W     | Wall/ceiling mount | 17LED        | 17W | CW                | Cool white - 5600K | FGC <sup>2</sup>   | Frosted heat treated glass |
|         |          |       |                    |              |     | WW                | Warm white - 3000K | GHA <sup>2</sup>   | Amber heat treated glass   |

### Notes

- Color variations may occur depending on the color temperature of the LED
- Standard with frosted heat treated glass (FGC) or Amber heat treated glass (GHA). For other globe options, order from accessory list below as separate line item.

**Special Projects:** We may be able to accommodate your special projects, so please don't hesitate to ask about additional options. Minimum order quantities and/or extended lead times will apply. Contact your Phoenix representative with specific inquiries.

## Accessories (order separately)

---

### Globes

GHC Clear heat treated glass

GPC Clear prismatic glass

PPC Clear polycarbonate prismatic - to be used without guard