

! CAUTION

- All wiring should be done by a licensed electrician in accordance with state codes, local codes and National Electric Code (NEC) standards.
- Improper installation may result in serious injury and void warranty.

Wiring

Install the male plug from the light head into the female receptacle adjacent to the switch in the arm assembly.

Install the male plug from the arm assembly into the nearest supply outlet (120V AC only). A rocker switch is built into the splice compartment on the arm assembly.

Green is ground (PE), black is line and white is common.

Modular Head Mounting

The modular light head is mounted to the Phoenix modular arm using a carriage bolt.

1. Install end cap.
2. Insert carriage bolt through arm, washer and then harp. Use lock washer and nut to secure as shown in Figure 1.

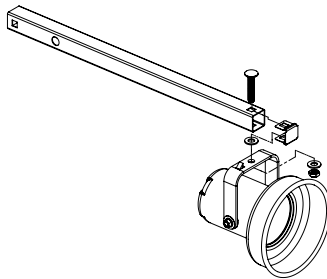
Figure 1**Arm Mounting**

This arm is designed for wall or post mounting and requires a flat vertical surface 5.00 inches (127 mm) wide and 17.00 inches (432 mm) high. Eight (8) ½ inch bolts are required for mounting (or ¾ inch bolts may be substituted, if desired).

Do not mount in a manner that will allow the wall arm to be trapped under an overhead door as it is closing nor be exposed to the elements.

The recommended mounting height is 78.00 inches (1981 mm) or higher.

Select a location and drill eight (8) holes using bracket for a template.

Double strut arms are compatible with all versions of the modular docklite head and can be mounted with a head below and fan above, with a fan below and a head above, or with two light heads.

Determine the desired orientation of the switchplate. In most cases, you will want the switchplate on the side of the arm facing away from the door. (In some cases the Phoenix label may be upside down.)

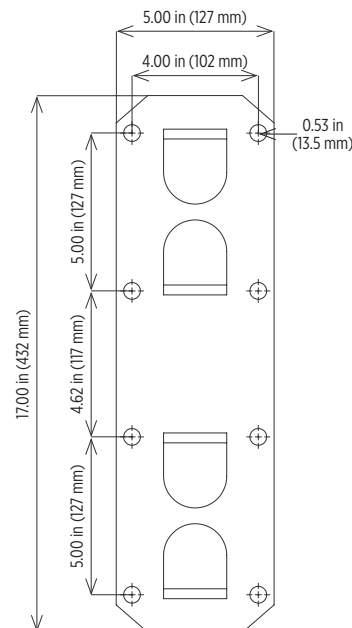
**Wall Mounting Plate for
Double Strut Arms**

Mounting Surfaces

If mounting to a solid surface, ½ inch lag bolts with lead anchors are recommended.

If mounting to a hollow wall with no access to the backside, toggle bolts with expansion wings should be used.

If mounting on a hollow wall with access to the backside, use ¾ inch bolts with large thrust washers under the nuts on the backside of the wall.

Flex Arm Feature

The 42 inch and 60 inch models are unique in that the outer arm can flex 240° vertically and 300° horizontally with a touch of the hand. The arms and light heads of all models will stay where directed without need of further loosening or tightening. We call this "Touch Control".

Touch control is also valuable in preventing damage from overhead doors or carelessly used fork lift trucks.

Normally the flexible arm joint will not require service for many years. If the normal tension should eventually loosen and allow the outer arm to droop, tighten the horizontal bolt just enough to restore the original action. Do not over tighten.



Repair Parts List

Item	Description	Model No. DL-42-ARM-DS	Model No. DL-60-ARM-DS
1	wall arm	1510043	1510041
2	lamp arm		1510045
3	wall mounting plate with bearing		2320380
4	tube, spacer		2698501
5	hexagon head cap screw		6031600
6	hexagon nut		6210600
7	spring washer		6320800
8	strain relief bushing		4030100
9	strain relief bushing		4030200
10	flat washer		6303300
11	end cover		5100600
12	tube, spacer		2657301
13	carriage bolt		6120200
14	cord set with plug		4130440
15	switch		4315004
16	receptacle		4055000
17	cover plate		2750164
18	jumper wire		4130090
19	ground wire		4130080
20	lock washer		6310800
21	hexagon nut		6205010
22	pan head screw		6002000



Modular Double Strut *docklite*® Arm Assembly

PHOENIX®
DURABILITY X DESIGN™

Installation Instructions

Repair Parts

Model No. DL-42-ARM-DS

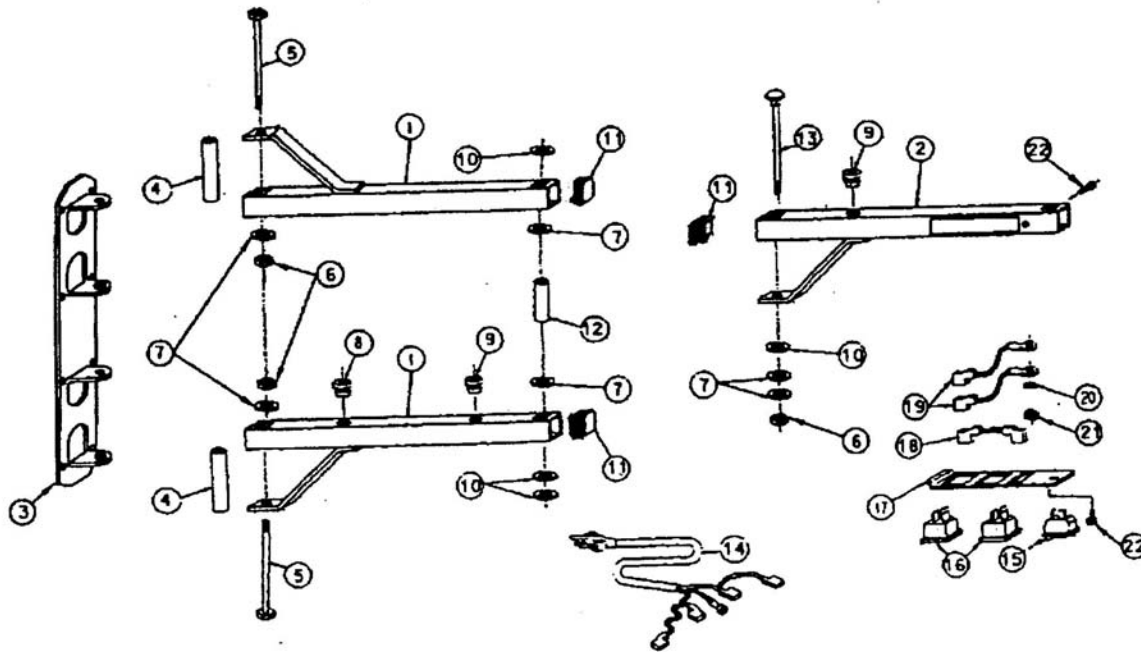

Model No. DL-60-ARM-DS

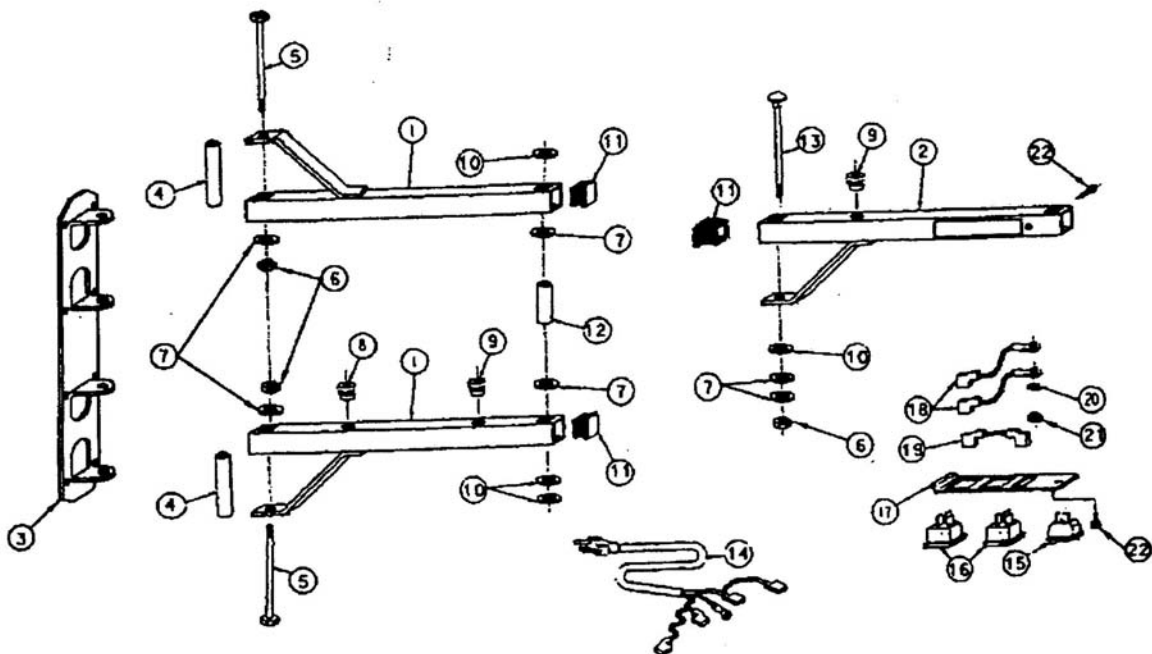

Product design and specifications are subject to change without notice.



Phoenix Lighting 8711 West Port Avenue Milwaukee, WI 53224 USA
Phone: +1 414.973.3300 Toll Free: 800.438.1214 Fax: +1 414.973.3210 www.phoenixlighting.com

N5610254A
1.06.21