

US Design Patent No. US D805,241 S

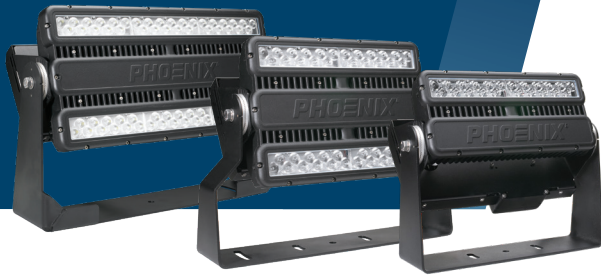

### Key Applications

#### Port Applications:

Rubber Tyred Gantry Cranes (RTG) • Ship-to-Shore Gantry Cranes (STS) • Mobile Harbor Cranes (MHC) • Rail Mounted Gantry Cranes (RMG) • Automated Stacking Cranes (ASC)

#### Maritime Applications:

Perimeter Lighting • Aft Wheelhouse Lighting • Aft Deck Rails • Bulwark Lighting • Cranes • Maintenance Hangars • High Bays • Dry Dock Lighting

#### Industrial Applications:

Exterior Perimeter Lighting • Gymnasiums • Workshops • Flag Lighting • Stadium Lighting • Tunnel Lighting • Bridge Lighting

### Compliances

#### ETL/cETL Certified to:

- UL 1598 Suitable for Wet Locations
- UL 1598A Marine Outside Type (Saltwater)
- CSA C22.2 No. 250.0 equivalent

CE

IP66

ABS

DLC (contact factory)

### Specifications

<b>Construction</b>	Marine grade, anodized and powder coated cast aluminum housing Adjustable powder coated steel mounting harp
<b>Finish</b>	Black thermoset powder coat finish
<b>Hardware</b>	Marine grade (316) stainless steel
<b>Power source</b>	120-277V, 50-60Hz; 277-480V, 50-60Hz; replaceable Overload, over-voltage, over-temperature and short-circuit protection 0-10V dimming option (DIM)



***This product complies with domestic preference requirements such as BAA or TAA.***  
*For additional information, visit [phoenixlighting.com](http://phoenixlighting.com) or consult your representative.*

### Specifications

<b>Lens</b>	Clear, tempered glass
<b>Surge protection</b>	4kV line to line; 2kV line to earth
<b>Light source</b>	Up to 125W (140), up to 240W (280), and up to 355W (420) - V2 Up to 14,000 lumens (140), up to 28,000 lumens (280), and up to 42,000 lumens (420) Cool white LEDs - standard Neutral white LEDs (NW) and warm white LEDs (WW) - optional CRI > 70 (CW) 50,000 hour rated life
<b>Wiring</b>	Stranded wires 17 gauge, 3 conductor cord - 72 inch (1829 mm) standard (CE and UL approved) Through wire optional (TW) (no cord provided) Standard cord grip 0.37 inch - 0.50 inch (9.5 mm - 12.7 mm)
<b>Ambient operating temperature</b>	-40°C to + 50°C Designed for use in areas allowing air flow
<b>Mounting</b>	360° harp rotation Indexed aiming and lockable in 5° increments Various mounting kits available (order separately)
<b>Vibration</b>	Meets requirements of ANSI C136.31-2010 Up to 6G for 100,000 cycles
<b>EPA (wind load)</b>	140 model - 2.1 sq. ft. (0.2 m <sup>2</sup> ) 280 model - 2.6 sq. ft. (0.2 m <sup>2</sup> ) 420 model - 3.3 sq. ft. (0.3 m <sup>2</sup> )
<b>Weight</b>	140 model - 23.2 lb (10.5 kg) 280 model - 32.2 lb (14.6 kg) 420 model - 54 lb (24.5 kg)
<b>Safety cable</b>	Safety cable included
<b>Warranty</b>	5 years

*For IES files, see website or contact factory*

# EcoMod® 2 Series

Heavy Duty LED Floodlight

**PHOENIX®**  
DURABILITY X DESIGN™

## Dimensions

### 140 Model

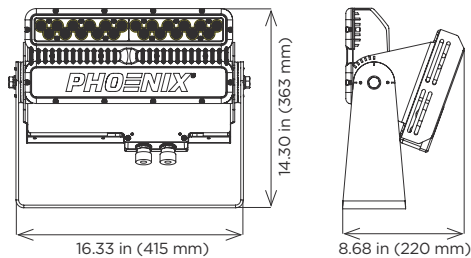

### 140 Model

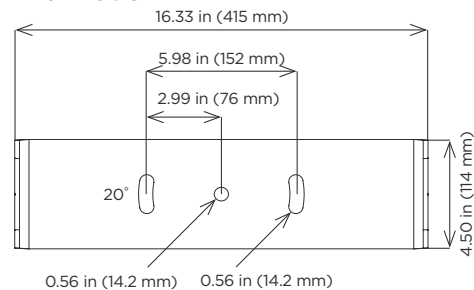

### 280 Model

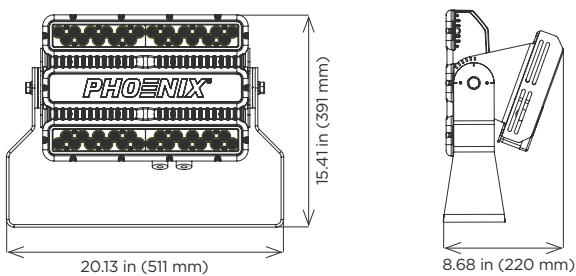

### 280 Model

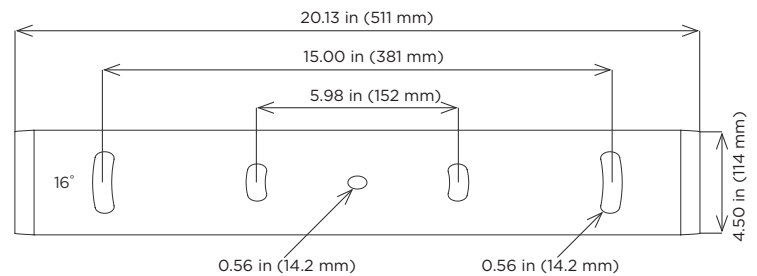

### 420 Model

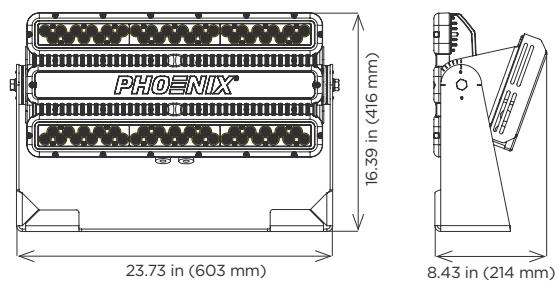

### 420 Model

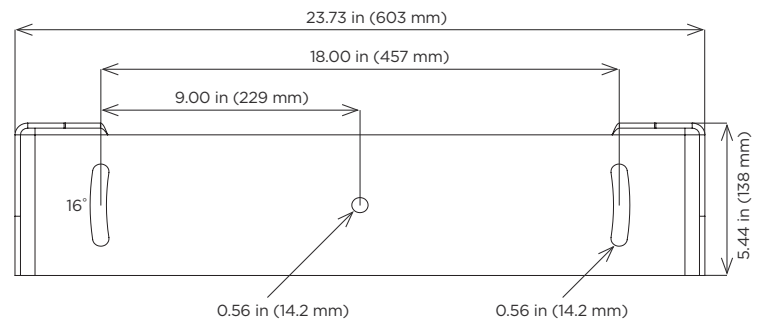

## Alternative Bracket Dimensions

### 140 Model

#### Bracket A

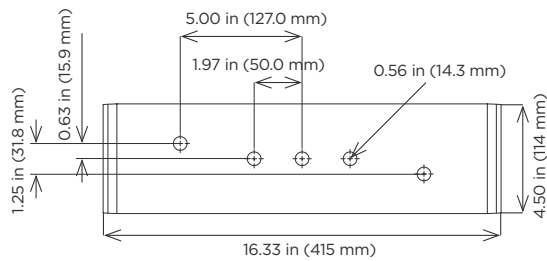

### 140 Model

#### Bracket B

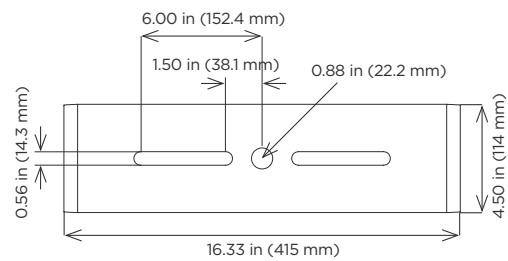

### 280 Model

#### Bracket A

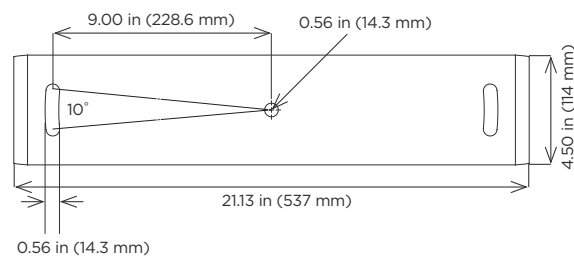

### 280 Model

#### Bracket B

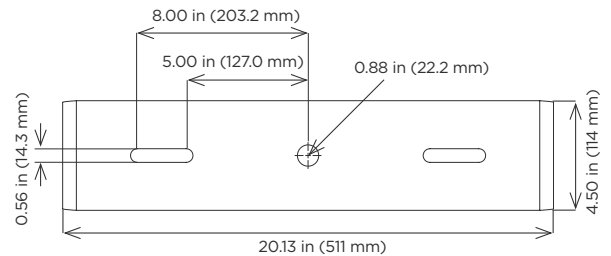

### 280 Model

#### Bracket C

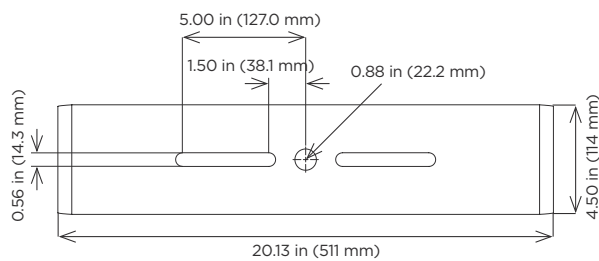

### 420 Model

#### Bracket A

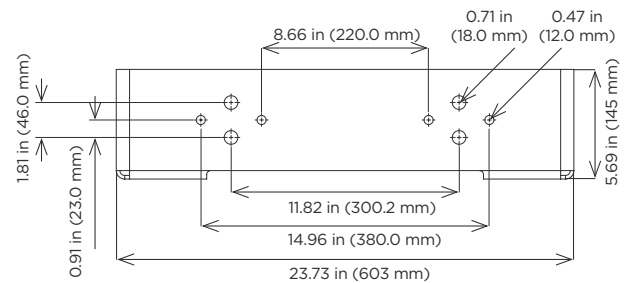

### 420 Model

#### Bracket B

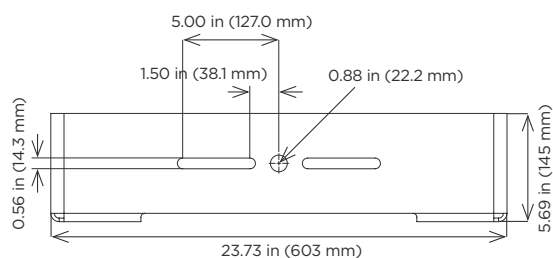

### 420 Model

#### Bracket C

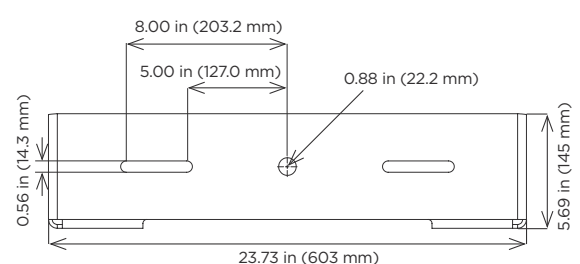

# EcoMod® 2 Series

Heavy Duty LED Floodlight

**PHOENIX®**  
DURABILITY X DESIGN™

## Ordering Information

**Example:** EM2-280-MF-120-277-V2

Fixture	Model	Optic	Voltage	Options	Alternative Brackets	Generation
EM2	140	WF	120-277	DIM <sup>2</sup>	BRKA	V2
	280	MF	277-480	WW <sup>1,3</sup>	BRKB <sup>4</sup>	
	420	WS		NW <sup>3</sup>	BRKC	
		SP		TW <sup>2</sup>		
		NS		DLC <sup>1</sup>		
		VS				

Model	Optic	Voltage	Options	Alternative Brackets	Generation
140 up to 125W	WF Wide flood	120-277 120-277V, 50-60Hz	DIM <sup>2</sup> Dimmable (0-10V)	BRKA Mounting bracket A	V2 Version 2
280 up to 240W	MF Medium flood	277-480 277-480V, 50-60Hz	WW <sup>1,3</sup> Warm white	BRKB <sup>4</sup> Mounting bracket B	
420 up to 355W	WS Wide spot		NW <sup>3</sup> Neutral white	BRKC Mounting bracket C	
	SP Spot		TW <sup>2</sup> Through wire		
	NS Narrow spot		DLC <sup>1</sup> DLC certified		
	VS Very narrow spot				

### Notes

- 1 Contact factory for availability
- 2 DIM & TW are not available together
- 3 Cool white LEDs - standard
- 4 Must order BRKB bracket on EM2-140 and EM2-280 when using with 2 3/4 inch Tenon Mount (PTM-MC2)

**Special Projects:** We may be able to accommodate your special projects, so please don't hesitate to ask about additional options. Minimum order quantities and/or extended lead times will apply. Contact your Phoenix representative with specific inquiries.

## Inrush Current

Model	Voltage	Inrush (i)	Duration
140	120-277	55A	0.9ms
140	277-480	50A	0.5ms
280	120-277	70A	1.2ms
280	277-480	50A	0.92ms
420	120-277	75A	0.7ms
420	277-480	50A	0.5ms

## Accessories (order separately)

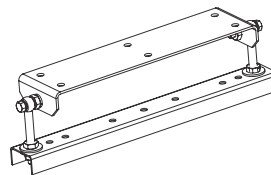

**Boom Mount Kit**  
BMK-LO/HI/MAX,MC2/MC3/EM2/EM3 (for use with standard mounting bracket)

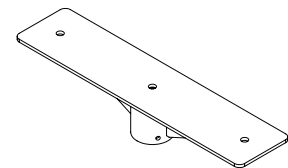

**2 3/4 inch Tenon Mount**  
PTM-MC2 (140 & 280 fixtures)<sup>1</sup>  
PTM-MAX420 (420 fixture)

### Notes

- 1 Compatible with EM2-140-BRKB and EM2-280-BRKB models only

Product design and specifications are subject to change without notice. The most current version of this specification sheet can be found at [www.phoenixlighting.com](http://www.phoenixlighting.com).