

! CAUTION

- All wiring should be done by a licensed electrician in accordance with state codes, local codes, National Electric Code (NEC) standards and International Electrotechnical Commission (IEC) standards.
- Improper installation may result in serious injury and void warranty.
- Keep plugs and receptacles dry. This fixture should only be used on Ground Fault Circuit Interrupter (GFCI) protected circuits.
- Contains parts and assemblies susceptible to damage by electrostatic discharge (ESD).
- When using luminaires, basic safety precautions should always be followed to reduce the risk of fire, electric shock and personal injury. When used in wet locations, circuit(s) or outlet(s) must have GFCI protection. Receptacles with built-in GFCI protection should be used for this measure of safety.

Included: two (2) surface mount brackets and two (2) suspension mount brackets.

To Adjust Fixture Wattage or Color Temperature

1. Loosen outer gear (Item 1) and hexagon nut (Item 9) from each end of fixture. This will allow the entire end cap assembly to be removed from the PC tube (Item 5).
2. Remove end cap assembly from PC tube (Item 5).
3. Remove LED assembly (Item 10) from PC tube (Item 5) by rotating the LED assembly 90° inside the PC tube (Item 5). The LED assembly (Item 10) should then slide out.
4. Locate output power and/or color temperature adjustment switches on driver. Adjust as required for your application. Refer to Figure 1.

Figure 1



5. Reassemble fixture by inserting LED assembly (Item 10) into PC tube.
6. Insert LED assembly (Item 10) into PC tube (Item 5) and rotate 90° so the LED assembly (Item 10) is between the notches in the PC tube (Item 5).
7. Insert entire end cap assembly into PC tube (Item 5).
8. Tighten outer gear (Item 1) and hexagon nut (Item 9) on each end of fixture.

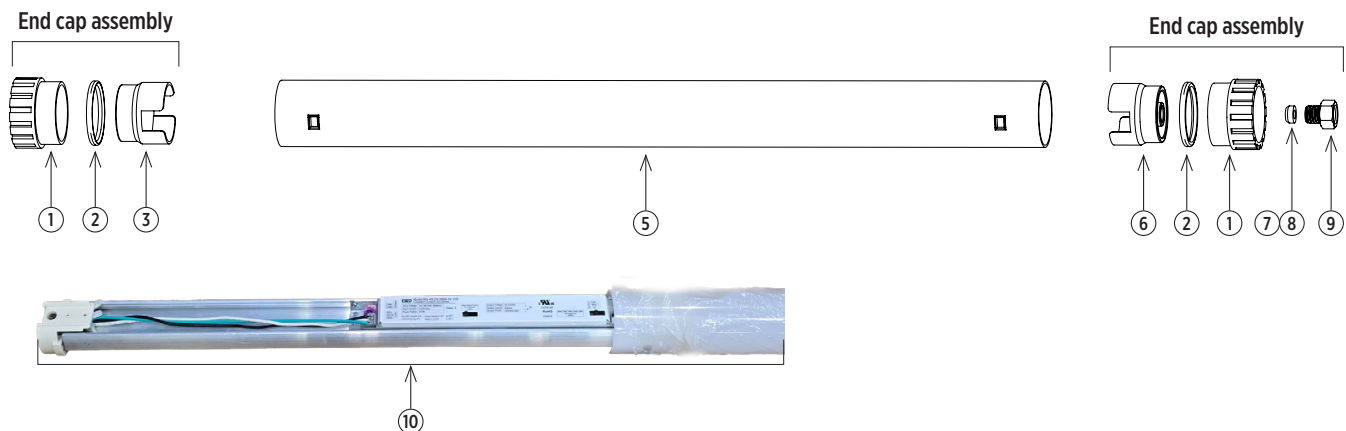

Figure 2: Surface Mount Bracket Dimensions

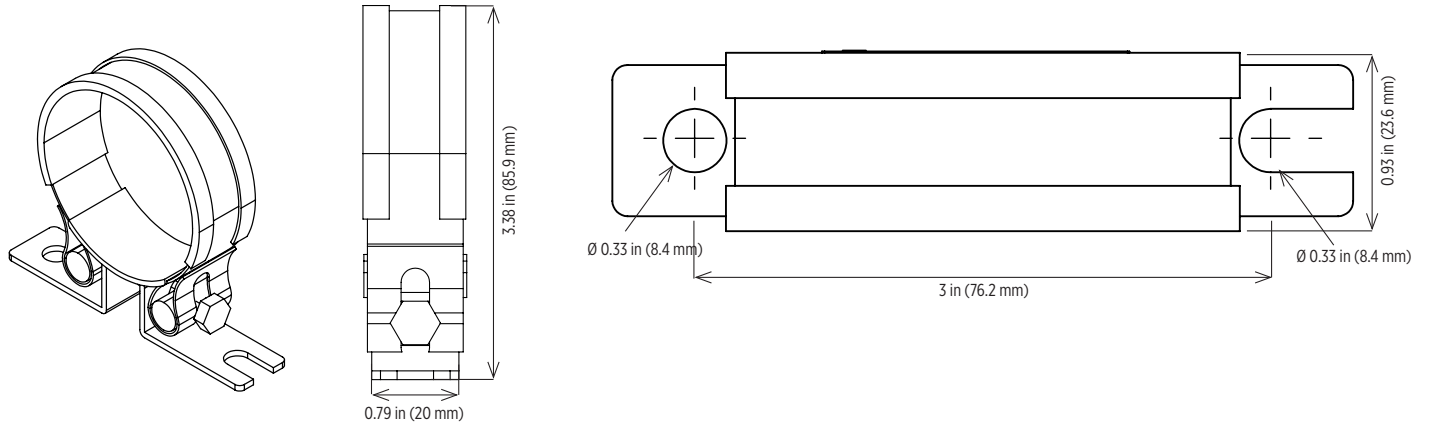
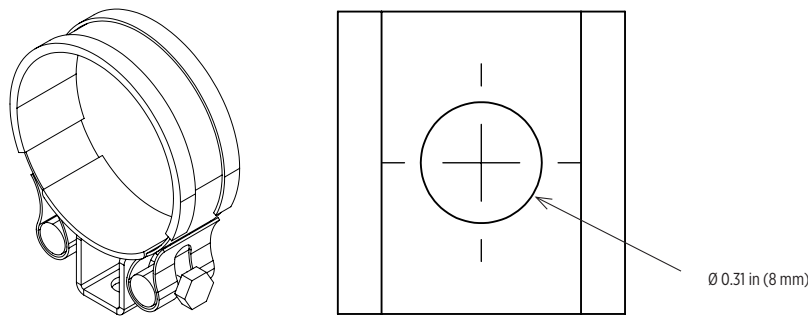

Figure 3: Suspension Mount Bracket Dimensions



Wiring

Standard Unit

black : line
white : neutral
green : ground

Wiring

EMB Unit

black: switched line
white: neutral
green: ground
red: charging line

Repair Parts

Item	Part Number
LEDLT2 driver kit	1091666
LEDLT2 EMB kit	1091667

Mounting

1. Fixture is provided with two styles of mounting brackets - Surface Mount (2 bolts/side) and Suspension Mount (1 bolt/side). Select the mounting type most suitable for the application.
2. Refer to the mounting bracket dimensions to prepare the attachment points in your installation location. Refer to Figure 2 & 3. Note: fasteners for mounting are not provided.
3. Open the stainless steel rings by loosening the tensioning bolts.
4. Slide the rings over the ends of the fixture, positioning them on the smooth part of the outer tube in a location that does not block the light-emitting portion of the fixture.
5. With the rings still somewhat loose, position the fixture in its final installation location and determine the desired aiming angle.
6. Tighten the tensioning bolts until the stainless rings are held firmly in place, making sure the light emitting portion of the light is still aimed in the proper direction.
7. Secure the mounting brackets to the desired mounting surface using appropriate hardware.

Maintenance

Periodic maintenance and cleaning is required to keep light fixture in peak operating condition. Buildup of dirt and/or debris will diminish performance, lead to premature failure and void the fixture's warranty.

1. Inspect fixture monthly or (more frequently if conditions require) for dirt and debris buildup on the lens and housing. Wash down with water as needed.
2. Inspect fasteners and verify cable fitting are sealed. Carefully retighten as needed, but take note that the threads are plastic and over-tightening may cause damage.

Product design and specifications are subject to change without notice.

