

! CAUTION

- All wiring should be done by a licensed electrician in accordance with state codes, local codes, and National Electric Code (NEC) standards or International Electrotechnical Commission (IEC) standards.
- Improper installation may result in serious injury and void warranty.
- Surge protective devices should be utilized for fixtures installed in environments subject to power surges outside the specified operating parameters.

Included in the ModCom® 2 Mounting Adapter Bracket Kit: four (4) M12 x 40 mm bolts, four (4) split washers, four (4) flat washers, four (4) nuts and one (1) adapter bracket.

Mounting

1. Mount adapter bracket to ModCom 2 fixture using provided hardware. Refer to Figure 1.
2. Fasten fixture with three (3) x ½ inch (M12) bolts (not provided) through center hole and slots in adapter bracket to a recommended torque of 25 foot-pounds. Use mounting dimensions shown in Figure 2. Attach near corner supports or use adequate subbase appropriate for the weight of the fixture.

Figure 1: Exploded View

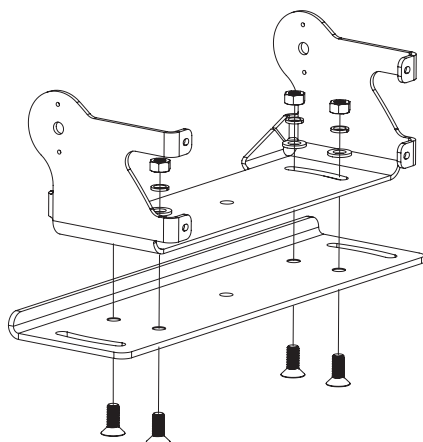

Note: Mounting adapter lip should be positioned on the front side of the fixture

Figure 2: Dimensions

