



**PHOENIX**<sup>®</sup>  
DURABILITY X DESIGN™

# MRSE Series

## Heavy Duty Floodlight



Heavy duty floodlight rated for hazardous and wet locations

Extreme shock and vibration resistance

Offers versatility with multiple wattage, lamping and optic options

For use on heavy duty equipment and in the world's harshest environments

### Dimensions

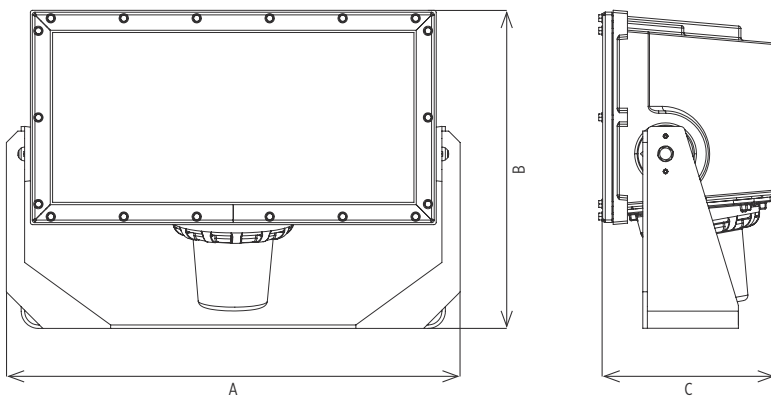

	400W	1000W
<b>A</b>	24.18 in (614 mm)	26.60 in (676 mm)
<b>B</b>	17.50 in (445 mm)	21.90 in (556 mm)
<b>C</b>	9.40 in (239 mm)	11.80 in (300 mm)
<b>Weight</b>	48.0 lb (21.8 kg)	64.0 lb (29.1 kg)



# MRSE Series

## Heavy Duty Floodlight

### Specifications

<b>Construction</b>	Marine grade, cast aluminum housing
<b>Finish</b>	Phoenix Green thermoset powder coat
<b>Hardware</b>	Marine grade external hardware
<b>Lens</b>	Heat- and impact-resistant ½ inch thick heavy duty tempered glass
<b>Light source</b>	High pressure sodium - E-18, 400W High pressure sodium - E-25, 1000W Pulse start metal halide - BT-37, 400W Metal halide - BT-56, 1000W Lamp not included
<b>Power source</b>	Shock- and vibration-resistant remote ballast available (BLST) <b>Required for complete installation (order separately)</b>
<b>Optic</b>	Available in narrow and wide
<b>Gasket</b>	High temperature silicone and EPDM gaskets
<b>Socket</b>	Silicone and EPDM rubber lamp isolation socket The multiplane socket float and lamp stabilizer absorb shock and vibration to extend lamp life
<b>Wiring</b>	Splice box is supplied with ½ inch NPT tapped hole
<b>Ambient operating temperature</b>	-40°C to +40°C
<b>Mounting</b>	Thermoset powder coated ¼ inch steel mounting bracket
<b>Safety Cable</b>	Secures fixture to structure Safety cable included
<b>Warranty</b>	1 year

### Compliances

UL Listed to:

- UL 1598 Ordinary Wet Locations
- UL 1598A Marine Outside Type (Saltwater)
- UL 844 Hazardous Location  
Class I, Division 2 Groups A, B, C, D  
Suitable for Wet Location

CSA Certified:

- Enclosure Type 4X (400W and 1000W only)

ABS

Meets Coast Guard Requirements



Meets the requirements of the  
Buy American Act (BAA) and/or the  
American Recovery and Reinvestment Act (ARRA)



## Ordering Information

Example: MRSE-400HPS-A

Fixture	Wattage/Type	Optic
MRSE	400HPS	A
	400PSMH	B
	1000	

### Wattage/Type

400HPS	400W high pressure sodium
400PSMH	400W pulse start metal halide
1000	1000W (high pressure sodium or metal halide)

### Optic

A	Narrow
B	Wide

**Special Projects:** We may be able to accommodate your special projects, so please don't hesitate to ask about additional options. Minimum order quantities and/or extended lead times will apply. Contact your Phoenix representative with specific inquiries.

## Accessories

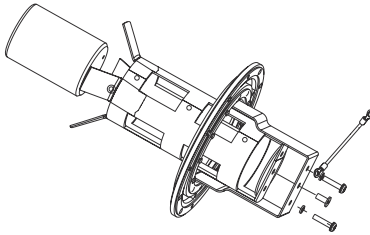

### Lamp Glove

BLS

Additional lamp support for severe shock and vibration applications  
(1000W only)



# MRSE Series

Heavy Duty Floodlight

**PHOENIX**<sup>®</sup>  
DURABILITY X DESIGN™

*Cover photo: MRSE fixtures installed on an electric rope shovel*

Product design and specifications are subject to change without notice. The most current version of this specification sheet can be found on our website: [www.phoenixlighting.com](http://www.phoenixlighting.com).



Phoenix Products Company Inc. 8711 West Port Avenue Milwaukee, WI 53224 USA  
Phone: +1 414.973.3300 Toll Free: 800.438.1214 Fax: +1 414.973.3210 [www.phoenixlighting.com](http://www.phoenixlighting.com)

**N56104520**  
10.20.15