

# PHOENIX®

## Installation Instructions and Repair Parts List for VP Series - Vaporproof fixture

### WARNING

Prior to performing maintenance, disconnect supply power from fixture.

#### GENERAL INFORMATION

Phoenix's nonmetallic vaporproof lighting products are available as complete fixtures in wall, ceiling or pendant mount configurations, and as retrofit fixtures which mate with existing junction boxes.

#### MOUNTING

For wall and ceiling mounts, attach the conduit box to the wall or ceiling. Run the leads to the conduit box (for wall mounts attach wall bracket to power module first and run leads through) and wire in the power module. Attach the conduit box to the power module using the screws supplied with the fixture. Then proceed to assemble lamp, globe, guard, and reflector as needed.

For the pendant mount, attach pendant cap to 3/4" threaded conduit and tighten the set screw. Wire in the power module and attach it to the conduit box using the screws supplied. Then proceed to assemble lamp, globe, guard, and reflector as needed.

#### LAMPING

Available with: Compact Fluorescent- 9W, 13W, 18W, 26W, 32W, 42W; or High Pressure Sodium or Metal Halide- 50W, 70W, 100W medium base lamps; or Incandescent -150W max.

#### BALLAST

The ballast used in this fixture is a self reset ballast. If the lamp goes out, the power supply needs to be de-energized in order to reset the ballast. **The lamp will not relight until this has been done.**

**NOTE: SCREW-IN, SELF-BALLASTED COMPACT FLUORESCENT LAMPS ARE NOT FOR USE IN ANY VP SERIES FIXTURE.**

#### WIRING

NOTE: While Phoenix VP Series fixture housings are non-conductive and do not need to be grounded, it is important that the ground of the conduit or other wiring method be maintained from one side of the fixture to the other.

#### Nonmetallic Wiring Methods

- Ground wire required
- Grounding lug in junction box for termination

#### Rigid and Intermediate Conduit

- Internal metal grounding strap provides hub-to-hub grounding
- Use 3/4" lock nuts on the inside of the box

#### EMT

- Can only be used with Phoenix retrofit fixtures.
- Use Phoenix retrofit fixtures and a standard metal 4" weatherproof box

#### Existing Metal Junction Boxes

- If metal junction box exists, grounding is not an issue
- Use Phoenix retrofit fixtures and the accompanying adapter ring

TYPE	LAMP
Incandescent	150W A21 Medium Base
9W CFL	CFQ9W/G23
13W CFL	CFQ13W/G24q
	CFTR13W/GX24q
18W CFL	CFTR18W/GX24q
26W CFL	CFTR26W/GX24q
32W CFL	CFTR32W/GX24q
42W CFL	CFTR42W/GX24q
HID	ED17 Medium Base

#### CAUTION

All wiring should be done by a licensed electrician in accordance with state and local codes plus NEC (National Electrical Code) Standards. Improper installation or use may result in serious injury. To prevent entry of water or moist air use thread sealant on all threaded entries. For freezer and similar applications the conduit to the fixture must be sealed to prevent moist air intrusion into the fixture through the conduit system.

## REPAIR PARTS ILLUSTRATION

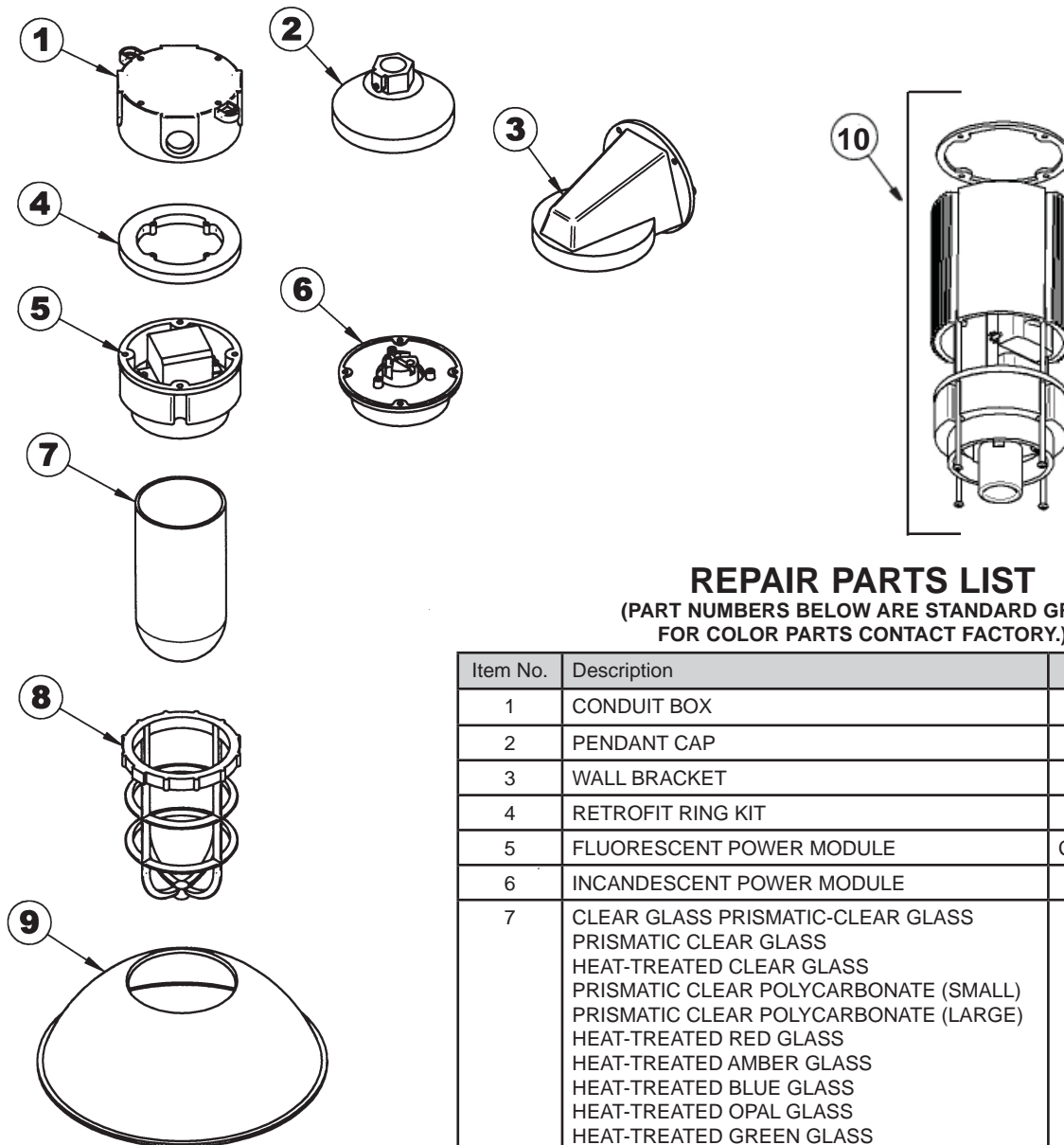

## REPAIR PARTS LIST

(PART NUMBERS BELOW ARE STANDARD GREY.  
FOR COLOR PARTS CONTACT FACTORY.)

Item No.	Description	Part No.
1	CONDUIT BOX	5110080
2	PENDANT CAP	5110081
3	WALL BRACKET	5110083
4	RETROFIT RING KIT	5110082
5	FLUORESCENT POWER MODULE	CONTACT FACTORY
6	INCANDESCENT POWER MODULE	5110070
7	CLEAR GLASS PRISMATIC-CLEAR GLASS PRISMATIC CLEAR GLASS HEAT-TREATED CLEAR GLASS PRISMATIC CLEAR POLYCARBONATE (SMALL) PRISMATIC CLEAR POLYCARBONATE (LARGE) HEAT-TREATED RED GLASS HEAT-TREATED AMBER GLASS HEAT-TREATED BLUE GLASS HEAT-TREATED OPAL GLASS HEAT-TREATED GREEN GLASS	4610016 4610017 4610018 4610019 4610020 4610021 4610022 4610023 4610024 4610025
8	GUARD	5110084
9	REFLECTOR	5110085
10	HID POWER MODULE ASSEMBLY	CONTACT FACTORY

### One Year Products Warranty -- (Limited Type)

Phoenix Products Company, Inc., warrants its products against defects in material and workmanship. Without charge, Phoenix Products Company will either repair or replace (Phoenix Products Company reserves the right to decide between repair or replacement) any properly installed Phoenix Products Company manufactured product which fails under normal operating conditions within one year from the date of invoice, provided it is returned to the factory (after authorization), transportation prepaid, and our inspection determines it to be defective under terms of this warranty.

The warranty covers only equipment manufactured by Phoenix Products Company and does not extend to transportation, installation, or replacement charges at buyer's facility; nor does it apply to any other equipment of another manufacturer used in conjunction with Phoenix Products Company equipment. No other warranty, expressed or implied, exists beyond that included in this statement.

# PHOENIX®

N5610225H-2