

PHOENIX[®]

INSTALLATION INSTRUCTIONS FOR LFP SERIES FLUORESCENT FIXTURES

CAUTION

All wiring should be done by a licensed electrician in accordance with state and local codes plus NEC (National Electrical Code) Standards. Improper installation or use may result in serious injury.

Before making any electrical connections, make sure power is turned off to the incoming wires.

GENERAL INFORMATION

Phoenix LFP Series fluorescent fixtures are

UL 1598 listed: Suitable for Wet Location

UL 1598A listed: Marine Outside Type (Saltwater) (WT unit)

cUL listed: Indoor/Outdoor Enclosure

Suitable for high pressure hose down

MOUNTING

Either of two mounting kits can be ordered separately; a chain mounting kit may be ordered in various lengths (Part No. 1090461 to 1090469). The last digit indicates the chain length in feet.

Optional fixed mounting brackets are also available (Part No. 1090470). See repair parts illustration on page 3.

WIRING

The fixture is supplied with a power cord that can be wired with a plug or directly to a junction box.

The green conductor is grounded to the fixture and must be connected to a positive ground.

DO NOT CONNECT GREEN (GROUND) WIRE TO POWER SOURCE.

LAMPING

From the end of the fixture opposite the power entry, remove the 3/8 inch hex-head screw. The end cap (Item 2 of Repair Parts on page 3) and outer tube can then be removed for lamping.

When relamping, it is recommended that the outer tube (Item 1 of Repair Parts on page 3) be cleaned to maintain fixture efficiently.

When lamping is complete, replace the outer tube and end cap. Be sure the o-ring seal is properly seated on the end cap before tightening the screws. **Do not over-tighten these screws.**

WARNING

- TO PREVENT HIGH VOLTAGE FROM BEING PRESENT ON BALLAST OUTPUT LEADS PRIOR TO INSTALLATION, INVERTER CONNECTOR MUST BE OPEN. DO NOT JOIN INVERTER CONNECTOR UNTIL INSTALLATION IS COMPLETE AND AC POWER SUPPLY IS CONNECTED TO THE EMERGENCY BALLAST.
- TO REDUCE RISK OF SHOCK, DISCONNECT BOTH NORMAL AND EMERGENCY POWER SUPPLIES AND INVERTOR CONNECTOR OF THE EMERGENCY BALLAST BEFORE SERVICING FIXTURE.
- DO NOT ATTEMPT TO SERVICE BATTERY INSIDE EMERGENCY BALLAST.

INSTALLATION OF FIXTURES WITH EMERGENCY BALLASTS (EMB SUFFIX)

1. For supply connections, use wire suitable for at least 90°C.
2. An unswitched power supply must be available for emergency ballast use. The unswitched lead must be fed from the same branch circuit as the switched lead.
3. To make electrical connections, remove lens and connect the following.
 - » Switched incoming (HOT) lead to red lead
 - » Unswitched incoming (HOT) lead to black lead
 - » Incoming neutral (COMMON) to white lead
 - » Ground to greenJoin inverter connection (red and white leads with integral plug/receptacle) of emergency ballast after connecting incoming leads. Install appropriate lamps. Close and latch lens frame.
4. Charge unit for 24 hours before use.

OPERATION OF EMERGENCY BALLAST

When A/C power is applied, the charging indicator light will be illuminated, indicating that the battery is being charged. When power fails, the emergency ballast automatically switches to emergency power (internal battery). The fixture will then operate one lamp at reduced illumination for at least 90 minutes.

A spot test of the emergency ballast function may be performed by removing lens and depressing test switch on lamp side of the reflector. One lamp should operate at reduced illumination while the switch is depressed.

For additional information, please refer to EMB system installation instructions provided.

REPAIR PARTS

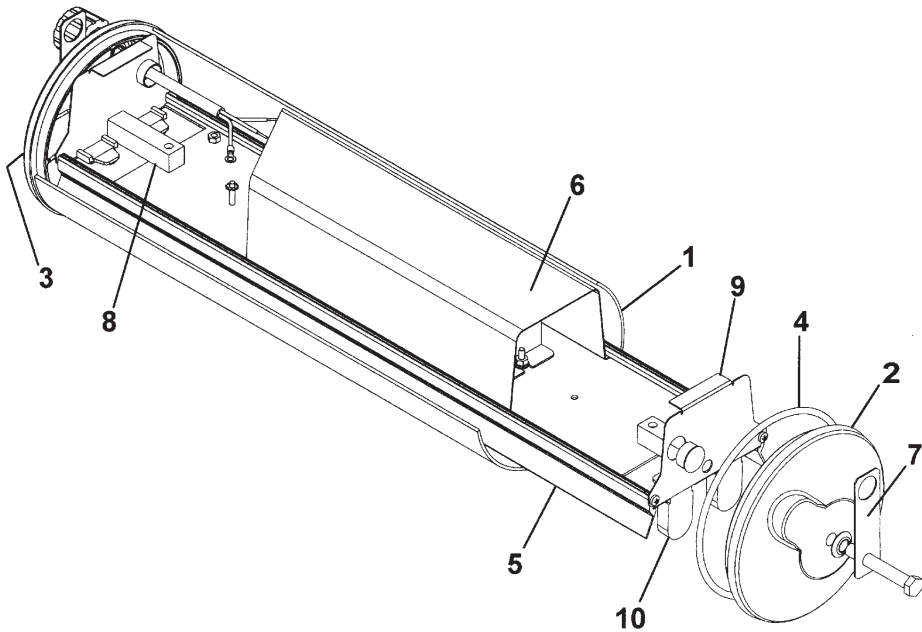

109046X*
(Optional)

*Digit #1-9 indicating length of each chain in feet

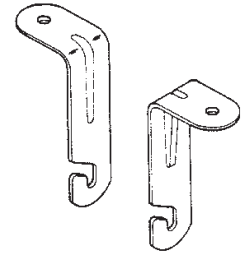

Fixed Mounting Kit (Optional)
1090470

ITEM	DESCRIPTION	2 FT.	4 FT.	8 FT.
1	Outer tube	3410005	3410006	3410007
2	End cap	5110040	5110040	5110040
3	End cap with conduit hole	5110041	5110041	5110041
4	O-ring	5020026	5020026	5020026
5	Reflector	2751170	2751171	2751172
6	Wire cover	2751190	2751191	2751191 (2 per fixture)
7	Stainless steel mounting brackets	2320231	2320231	2320231
8	Bolt anchor	6605003	6605003	6605003
9	End plate (rapid start models)	2751210	2751210	-----
	End plate (slimline)	-----	-----	2751220
	End plate (HO models)	-----	2751220	2751220
	End plate (T5 HO models)	-----	2751225	-----
10	Lamp sockets (rapid start models)	Contact Factory	Contact Factory	Contact Factory
	Lamp sockets (slimline)			
	Lamp sockets (HO models)			
	Lamp sockets (T5 HO models)			
11	Emergency Ballast*	-----	4370087	4370087

*Emergency units only

LAMP DATA

Rapid Start Lamps

Fixture Model No.	Lamp Type	Wattage
LFP217	F17T8	17
LFP220	F20T12	20
LFP432	F32T8	32
LFP440	F40T12	40

Slimline Lamps

Fixture Model No.	Lamp Type	Wattage
LFP875	F96T12	75

High Output Lamps

Fixture Model No.	Lamp Type	Wattage
LFP454	F54T5HO	54
LFP460	F48T12HO	60
LFP886	F96T8HO	86
LFP8110	F96T12HO	110

ONE YEAR PRODUCT WARRANTY — (LIMITED TYPE)

Phoenix Products Company Inc. warrants its products against defects in material and workmanship. Without charge, Phoenix will either repair or replace (Phoenix reserves the right to decide between repair or replacement) any properly installed Phoenix manufactured product which fails under normal operating conditions within one year from the date of invoice, provided it is returned to the factory (after authorization), transportation prepaid, and our inspection determines it to be defective under terms of this warranty.

The warranty covers only equipment manufactured by Phoenix and does not extend to transportation, installation, or replacement charges at buyer's facility; nor does it apply to any other equipment of another manufacturer used in conjunction with Phoenix equipment. No other warranty, expressed or implied, exists beyond that included in this statement.